

Community Forum
Private Bag 4999
Christchurch 8140

**Meeting notes for the meeting of the CERA Community Forum
Thursday 19 September 2013, 6.00pm
Canterbury Club, Cambridge Terrace**

Present:

Community Forum members:

Richard Ballantyne, Leah Carr, Martin Evans, Ruth Jones, Trevor McIntyre, Faye Parfitt, John Peet, Patricia Siataga, Emma Twaddell, Brian Vieceli, Siong Sah (John) Wong

Apologies

Weng Kei Chen, Tom McBrearty, Deborah McCormick, Lesley Murdoch, Jocelyn Papprell, Rachel Vogan

Wendy Gilchrist, Paul Lonsdale and Bruce Russell (on leave while standing in the local government elections)

Hon Amy Adams, Associate Minister for Canterbury Earthquake Recovery

Chair

Darren Wright

In Attendance

Rob Kerr, Development Director – Anchor Projects, Christchurch Central Development Unit, CERA
Amanda Shaw, Acting Manager, Ministerial and Executive Services, CERA

Agenda

1. Notes of the previous meeting

a. Moved

That the meeting notes from 5 September 2013 meeting be confirmed as an accurate record.

Carried

b. Matters arising

Belinda Charteris has resigned from the Forum.

2. Avon River Precinct and the North and East Frame – Rob Kerr, CERA

Rob Kerr gave a presentation on progress of planning for the Avon River Precinct and the North and East Frame in the Christchurch Central Recovery Plan:

- Largest urban river project in New Zealand's history.
- Fundamentally it's about supporting the economy of the central city by creating a place for people to be.
- Consortium of national and international consultants involved in design.
- A video of the Avon River Precinct has just been released and is available on the CCDU website at <http://ccdu.govt.nz>
- Antigua to Durham section – north facing, wide promenades, fronting the Health Precinct.

- Durham to Armagh section ("The Terrace") – promenade frontage with wide broad terracing, new informal gathering centre, space for a stage on the left bank of the river, softer landscaping on the left bank.
- Victoria/Market Square – gateway to the central city, corridors to key points in the city, creating a space or platform for events such as markets and civic functions to happen.
- The North Frame (Colombo to Manchester) – English-style garden landscaping, opportunity for a community orchard framed by residential development. CERA is working with the families of victims in relation to the future of sensitive sites (PGC and CTV buildings).
- The Family Playground (Margaret Mahy's Amazing Place) – aiming to be an all-ages attraction; potential for a community garden, lookout, art displays, cafes etc.
- Avon Loop – native planting but generally limited intervention in the natural environment.
- East Frame – want to encourage people to live in the central city, medium density housing over time, 1500-2000 people living in the East Frame around a great public space.

Feedback from the Forum:

- There are some community groups who would seize the opportunity to create a community garden.
- Overseas visitors have noted that what they like about New Zealand playgrounds is that they are not "over-the-top" with safety precautions – safe but not over-cautious.
- Need to think about how to bring the community along with these positive developments. Greater Christchurch residents need a lift at the moment before going into the summer break. Members of some groups, such as the elderly, may find it more difficult to access online information and videos.
- But there is a balance to be struck between engaging the community and ensuring momentum continues. The main thing is to ensure that information is shared with the community.
- Need to emphasise that the public spaces are there for the community to use.
- Accessibility considerations should focus not just on accessibility within the spaces, but also enabling people to get from place to place in easy and interesting ways. (Rob Kerr noted that the Barrier Free Trust is on the audit group).

Action point:

D Wright to forward contact details to CERA for a group that would be interested in establishing a community garden in the CBD.

CERA representative will forward public release material on the River Precinct and the North and East Frame to Forum members once it has been finalised.

CERA will consider how to share information about progress on the River Precinct and the North and East Frame with the different communities within greater Christchurch.

3. Future Hub – Mark Rackley Gale, BNZ

Mark Rackley Gale gave a presentation on the Future Hub established by BNZ:

- a free advisory service for people affected by the earthquakes
- partnered up with other agencies who can help, eg, IAG, AON, CETAS, RAS, Pathways
- 130 inquiries in the first two weeks of operation
- issues/challenges for people wanting to borrow or to buy predominantly related to insurance and uncertainty about what their current options are

- emerging issue around funding for retaining wall repairs and betterment – difficulties relate to insurance and the recently introduced loan-to-value ratio restrictions.

Action point:

CERA representative to forward on concerns raised about difficulties securing funding for retaining walls betterment to the relevant team within CERA.

4. Upcoming meetings

The Chair noted that he has had a discussion with the Associate Minister for Canterbury Earthquake Recovery, Hon Amy Adams about the role of the Forum moving forwards. The Forum agree that a brainstorming session on “Where to from here?” with the Associate Minister and/or the Minister for Canterbury Earthquake Recovery in the near future would be useful.

Next Meeting – Thursday 3 October 2013, Canterbury Club, Cambridge Terrace
Meeting closed 7:45pm

RELEASED UNDER THE OFFICIAL INFORMATION ACT 1982

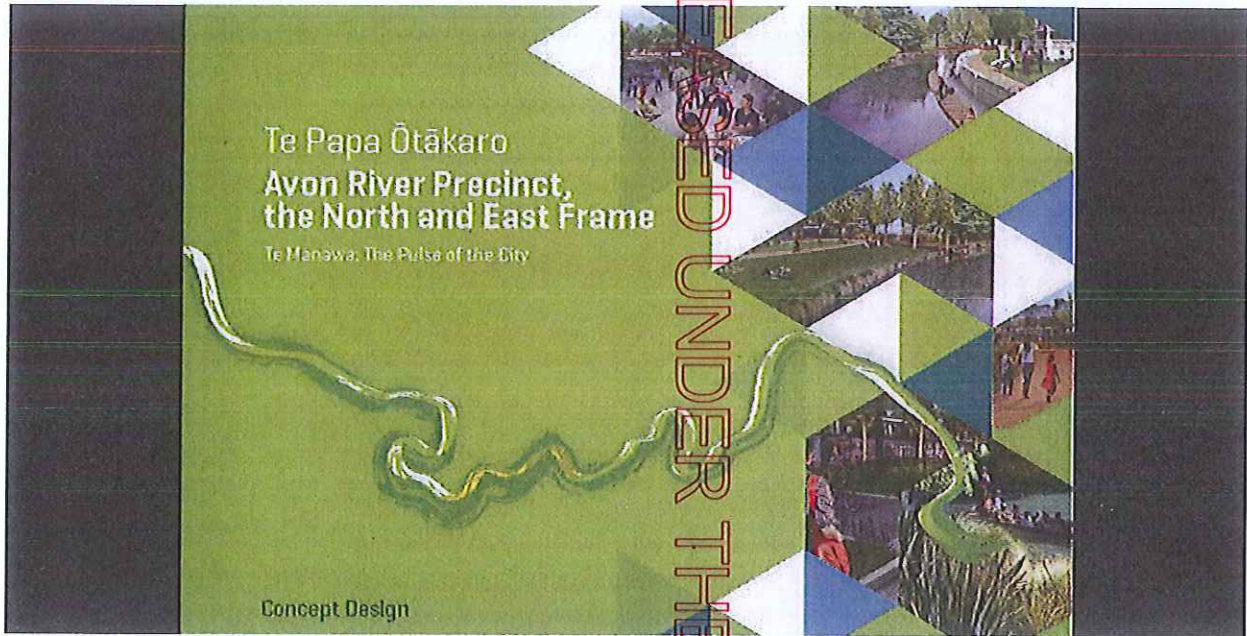

RELEASED UNDER THE OFFICIAL INFORMATION ACT 1982

OUR VISION

"KIA ATAWHAI KI TE TANGATA"

CARE FOR THE PEOPLE

PITA TE HORI (1861)



A PLACE FOR PEOPLE

THE KEY PRINCIPLES

- A Healthy Place - Healthy Mahinga Kai
- A Distinctive Place - Weaving cultures together
- An Accessible Place
- A Prosperous Place

A Place for People

THE MAIN ELEMENTS

- Promenade the full length of the river
- Continuous cycleway the full length of the river
- Strong ecological enhancement (bringing back the bellbirds and the inaka)
- Community gardens and places for hospitality
- Three main activity areas
 - The Terrace (Durham to Armagh), Victoria Square and The Family Playground
- High quality lighting and safe design
- Strong settings for our history and culture
- An Art and Sculpture trail
- A new residential community



RELEASED UNDER THE OFFICIAL INFORMATION ACT 1982

RELEASED UNDER THE OFFICIAL INFORMATION ACT 1982

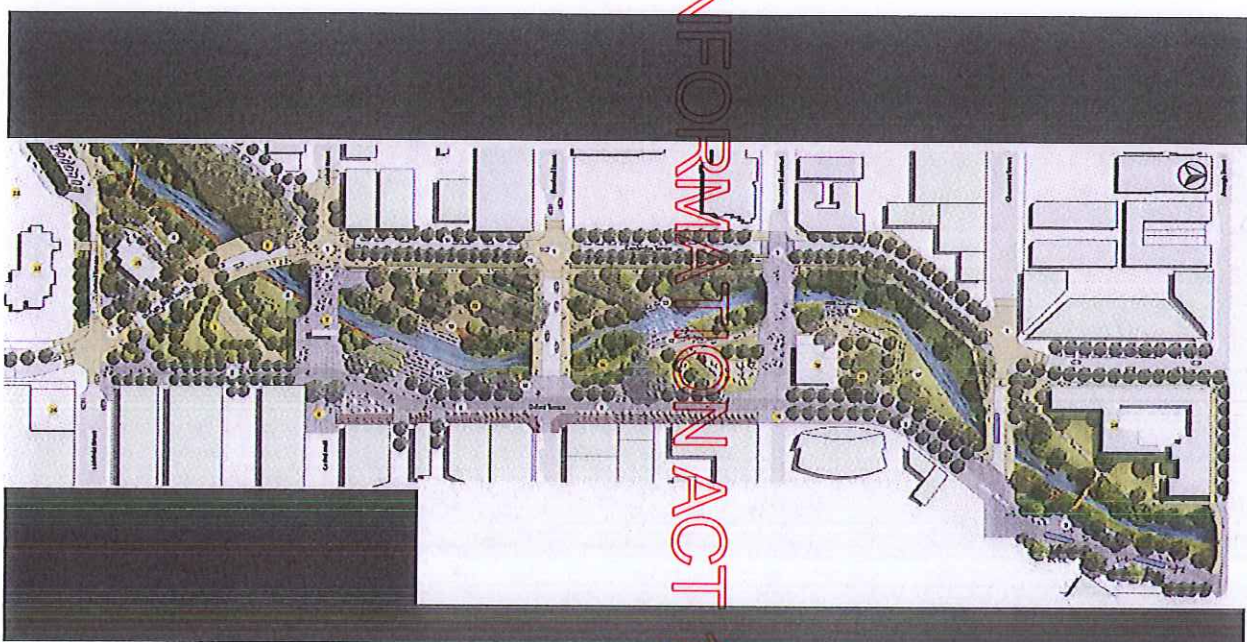
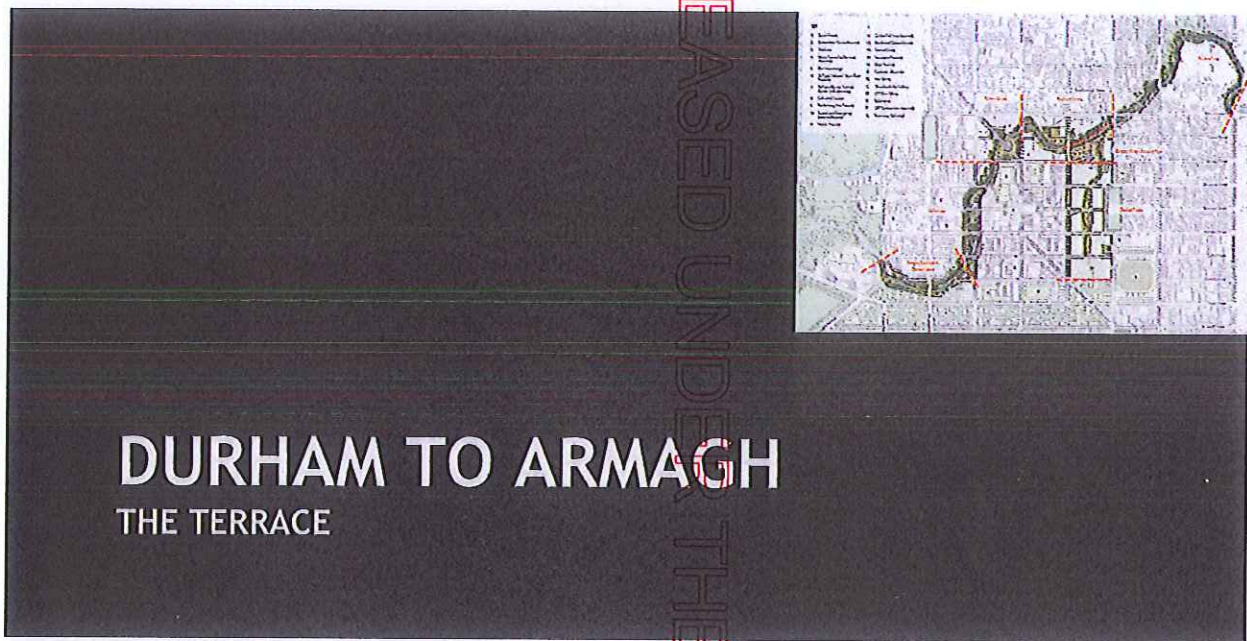



RELEASED UNDER THE OFFICIAL INFORMATION ACT 1982

RELEASED UNDER THE OFFICIAL INFORMATION ACT 1982



VICTORIA/MARKET SQUARE

RELEASED UNDER THE OFFICIAL INFORMATION ACT 1982

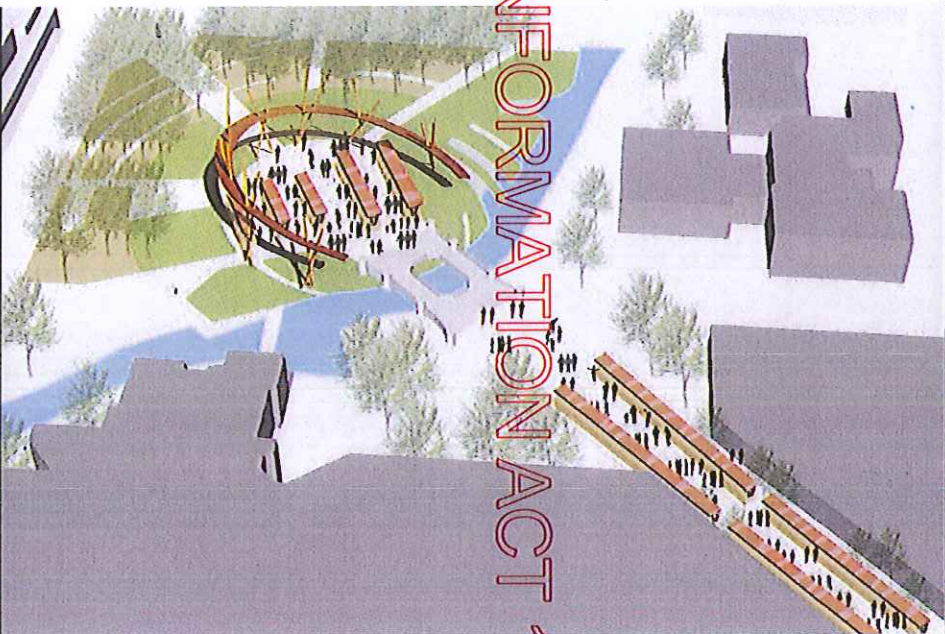
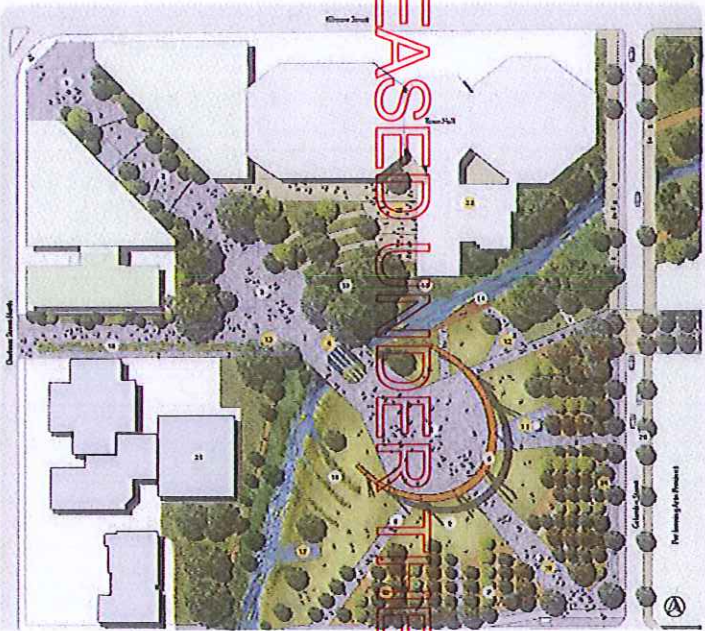

RELEASED UNDER THE OFFICIAL INFORMATION ACT 1982



**THE NORTH FRAME
COLOMBO TO MANCHESTER**

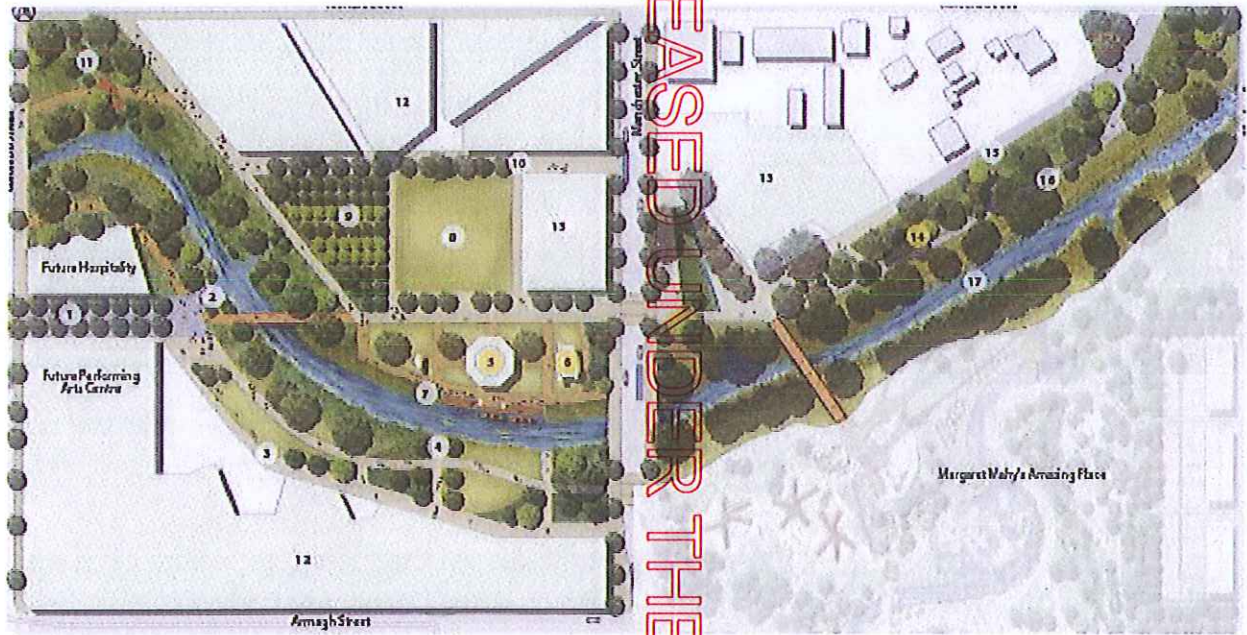

RELEASED UNDER THE OFFICIAL INFORMATION ACT 1982

RELEASED UNDER THE OFFICIAL INFORMATION ACT 1982



THE FAMILY PLAYGROUND

MARGARET MAHY AMAZING PLACE



RELEASED UNDER THE OFFICIAL INFORMATION ACT 1982



THE AVON LOOP

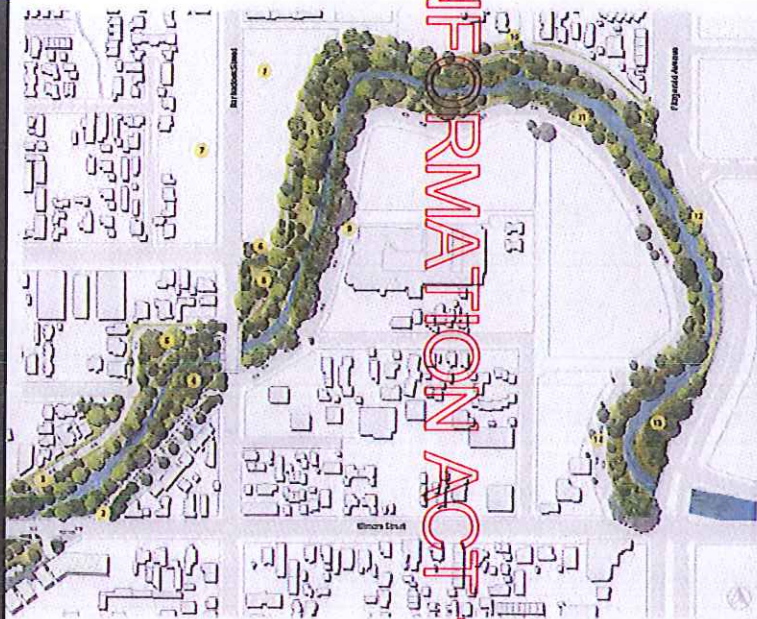

RELEASED UNDER THE OFFICIAL INFORMATION ACT 1982

RELEASED UNDER THE OFFICIAL INFORMATION ACT 1982

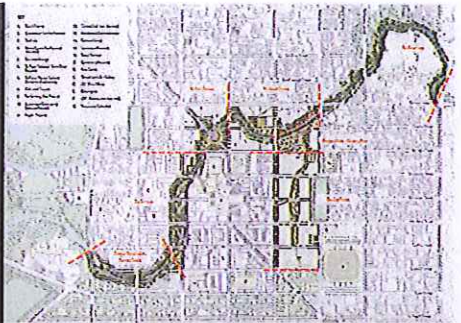
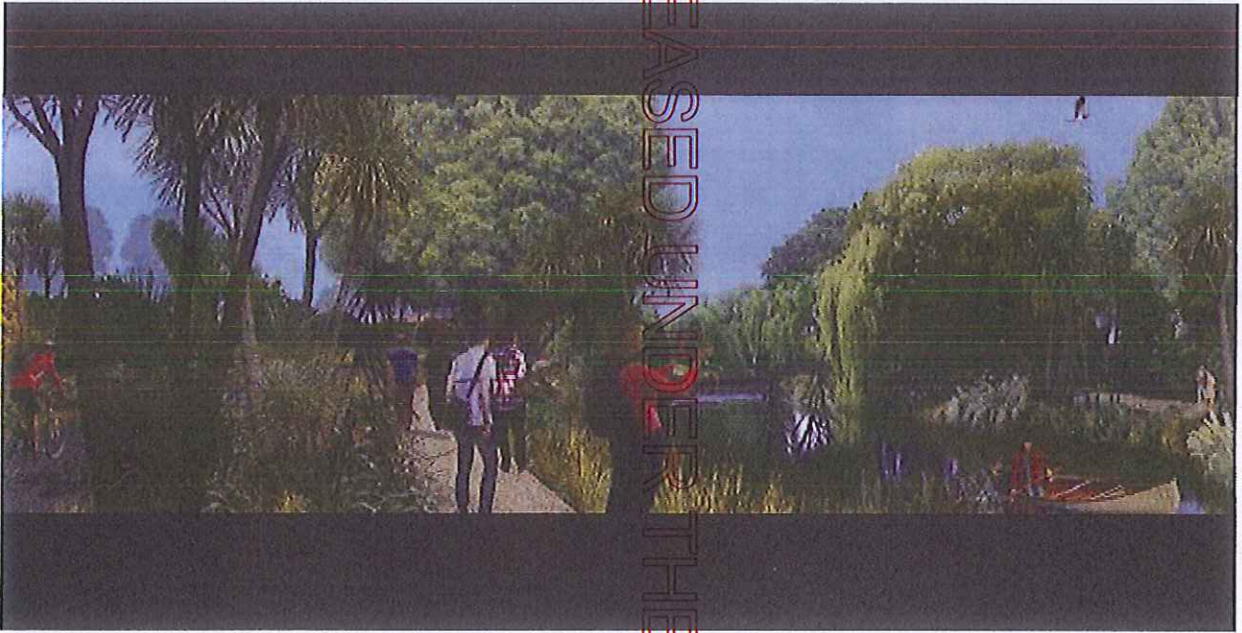

THE EAST FRAME

RELEASED UNDER THE OFFICIAL INFORMATION ACT 1982

Madras Street

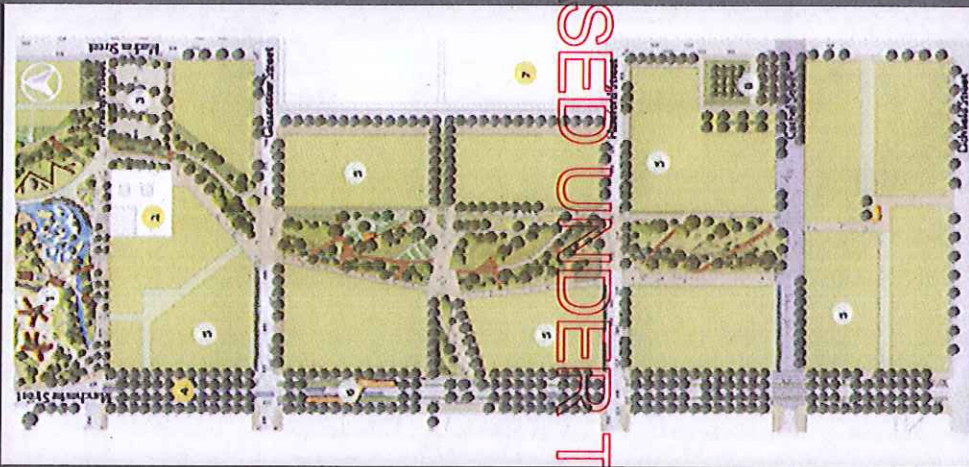

Manchester Street

The East Frame in 2015



trav city apartments around a communal courtyard



trav city town houses with plots to gardens

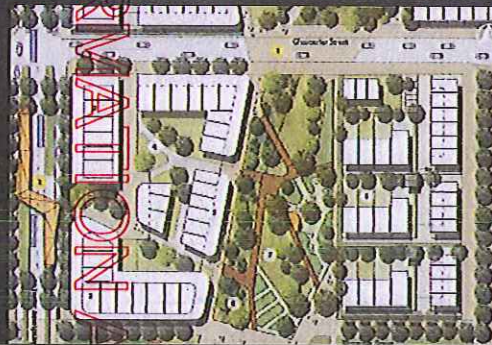

RELEASED UNDER THE OFFICIAL INFORMATION ACT 1982

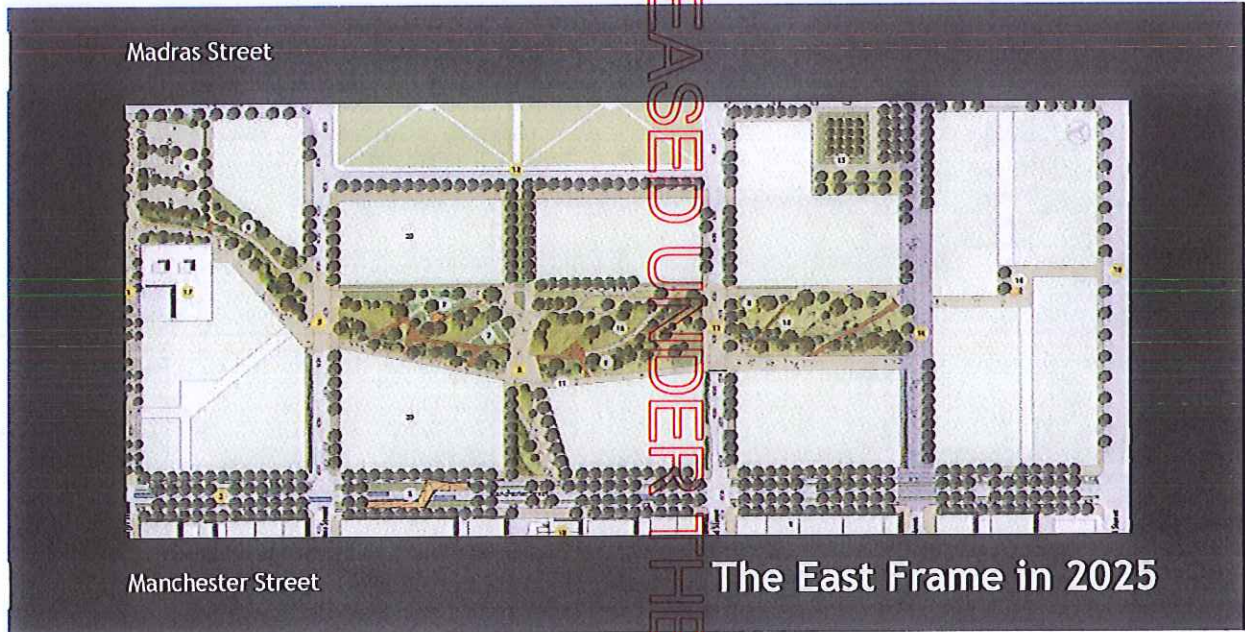

NEXT STEPS

- Further consultation with Ngai Tuahuriri
- Establish integrated design and review process
- Assemble design team for next phases
- Business case and budget finalisation
- Prepare strategy for residential development
- Procurement and design leading to..
 - Construction commencing in November 2013 (In the river)
 - Main landscape works commencing in early 2014
 - Completion of public realm mid 2015

QUESTIONS ?



RELEASED UNDER THE OFFICIAL INFORMATION ACT 1982